

# Futuro Futuro

## RANGE HOOD

### INSTALLATION MANUAL

#### MODEL: RECANO ISLAND

#### (40" & 60" VERSIONS)

##### NOTE: PRIOR TO INSTALLATION

Please inspect range hood visually, as well as connect it to power supply and test its operation.

##### 1 Recommended Installation Height

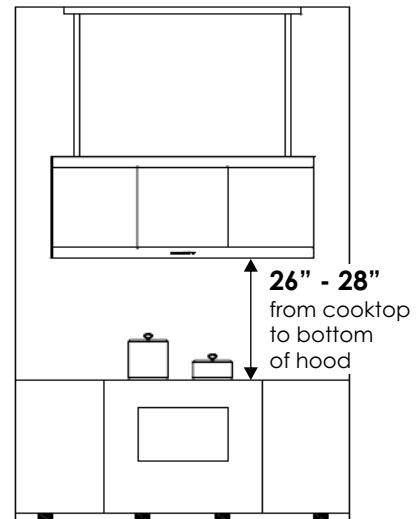

##### 2 MOUNTING PLATE DIMENSIONS

NOTE: Inch dimensions are approximate, and given for reference / convenience only. Always measure the actual items on-site and make drilling / cutting marks according to actual materials & measurements.

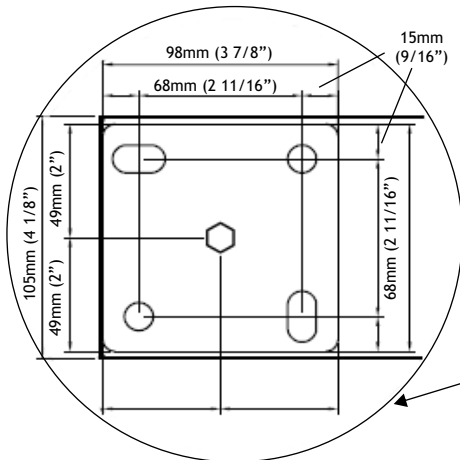

##### 3 MOUNTING PLATE SPACING

NOTE: Inch dimensions are approximate, and given for reference / convenience only. Always measure the actual items on-site and make drilling / cutting marks according to actual materials & measurements.

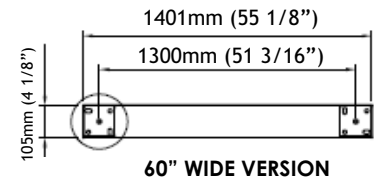
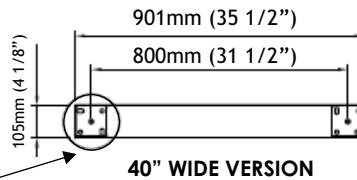

##### 4 ATTACH MOUNTING PLATES TO CEILING

- 1.) Drill holes in ceiling / joists / plywood, to match holes in mounting plates.
- 2.) Attach mounting plates to ceiling, using the provided screws & washers.

NOTE: Concrete / masonry ceilings ONLY - use anchors as needed.

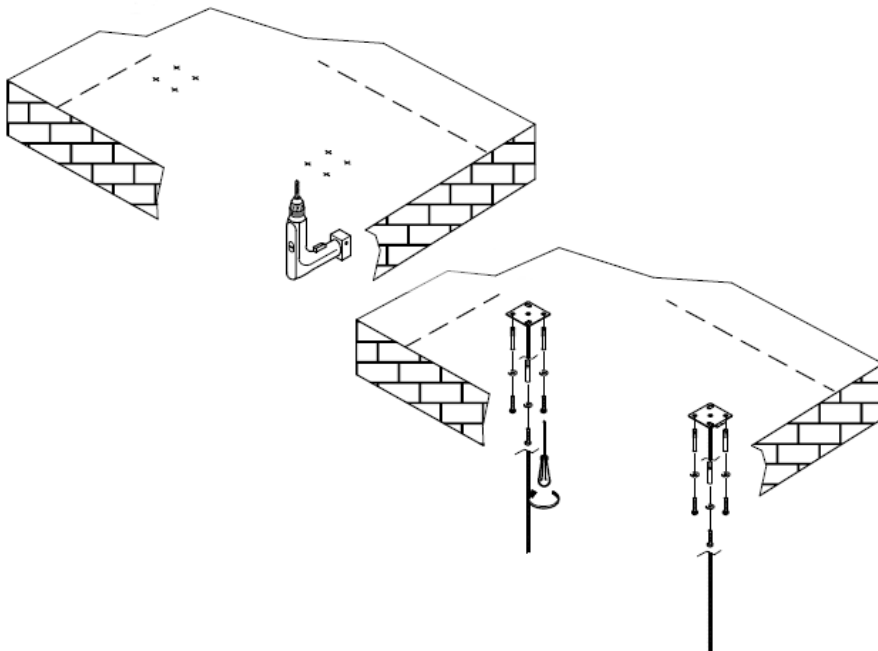

##### 5 REMOVE PANELS FROM HOOD

- 1.) Locate cover panels on top of range hood.
- 2.) Remove screws holding panels in place.
- 3.) Remove panels.

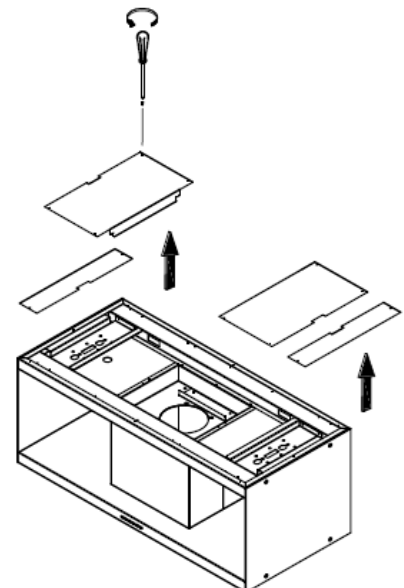

**6****PREPARE POWER CORD**

- 1.) Locate the power cord.
- 2.) Thread power cord through hole in range hood body, as shown.

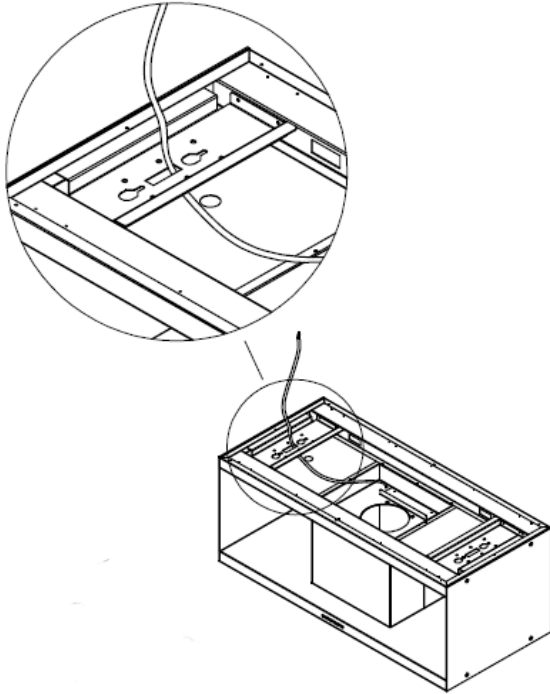
**7****ASSEMBLE SUPPORT STRUCTURE**

- 1.) Slide horizontal trim plate onto vertical rod covers.
- 2.) Slide rod covers onto threaded rods.
- 3.) Secure bottoms of rods with brackets, washers and nuts.

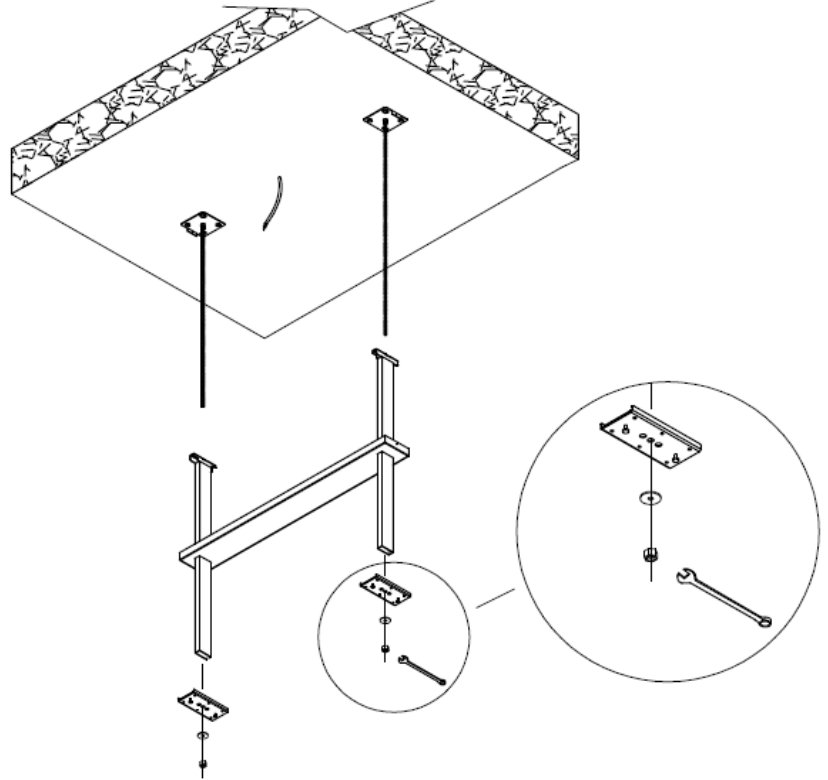
**9****CONNECT POWER CORD TO POWER LINE**

- Connect the power cord to the power line in the ceiling, in accordance with your local building codes.

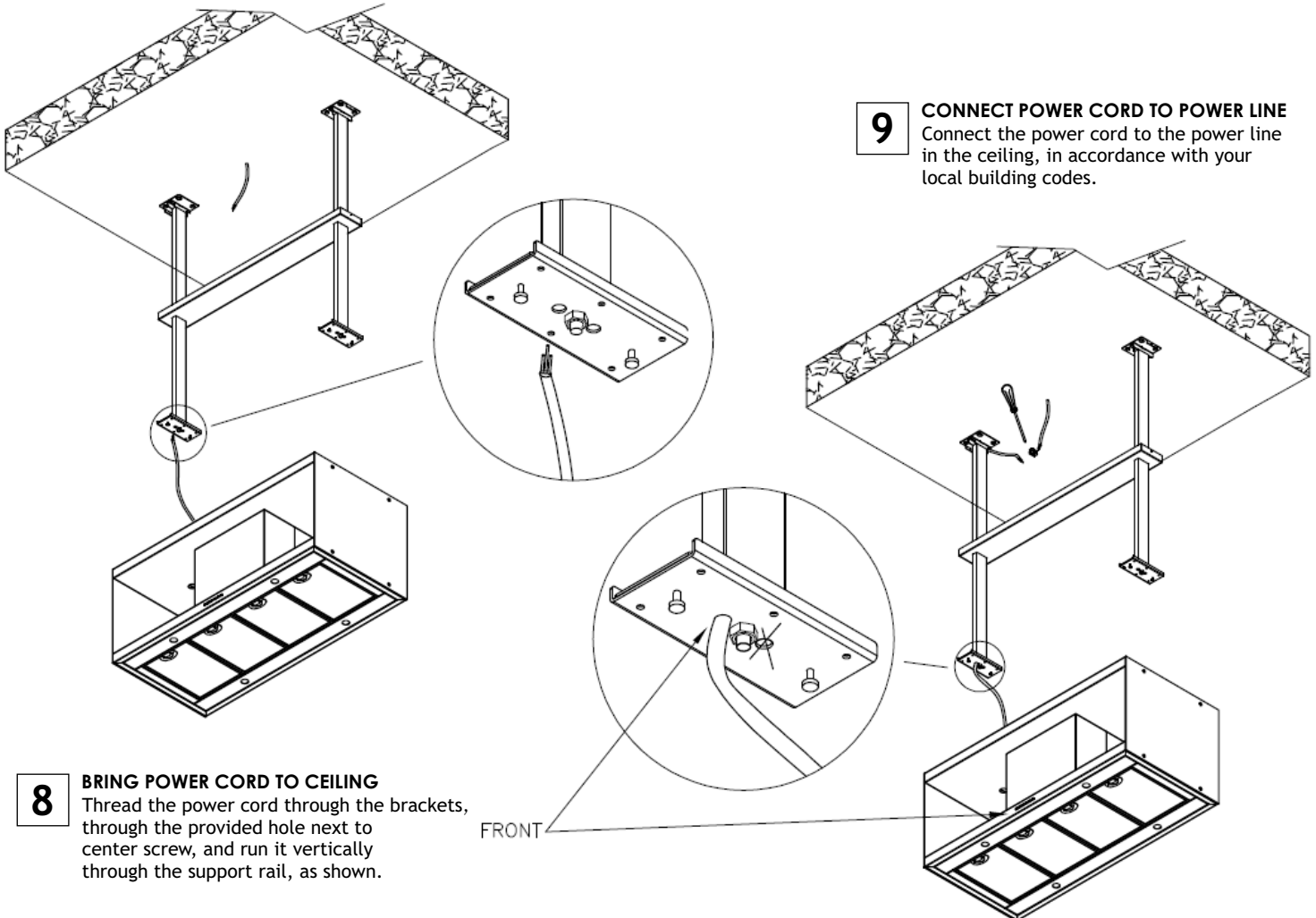
**8****BRING POWER CORD TO CEILING**

- Thread the power cord through the brackets, through the provided hole next to center screw, and run it vertically through the support rail, as shown.

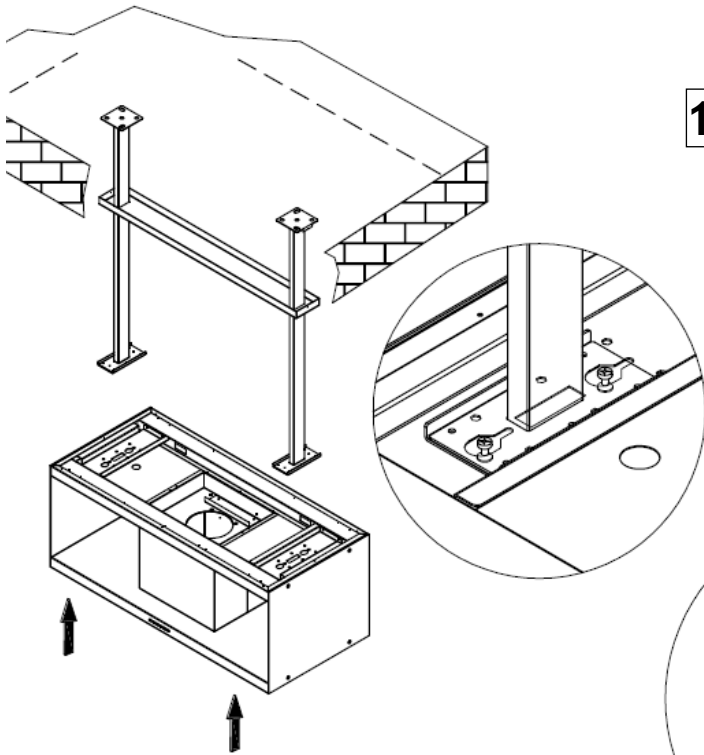

- 10 ATTACH HOOD TO SUPPORT BRACKETS**  
 1.) Raise hood body and slide mounting screws into matching holes on support brackets.  
 2.) Secure hood to both bracket with screws.

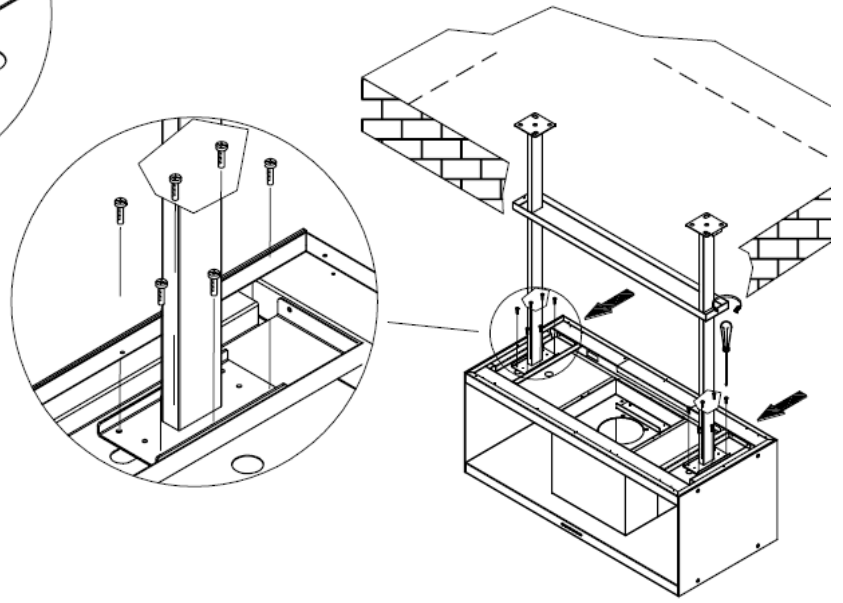

- 11 REPLACE COVER PANELS**  
 1.) Replace the cover panels (that were removed in Step 5.)  
 2.) Secure panels with original screws.

- 12 LEVEL TOP BRACKETS**  
 Adjust the vertical level with screws.

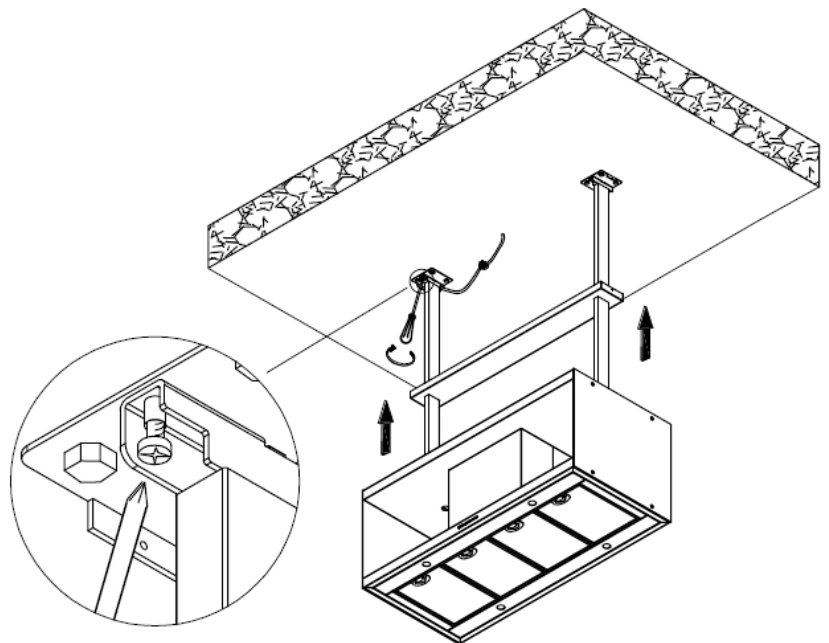
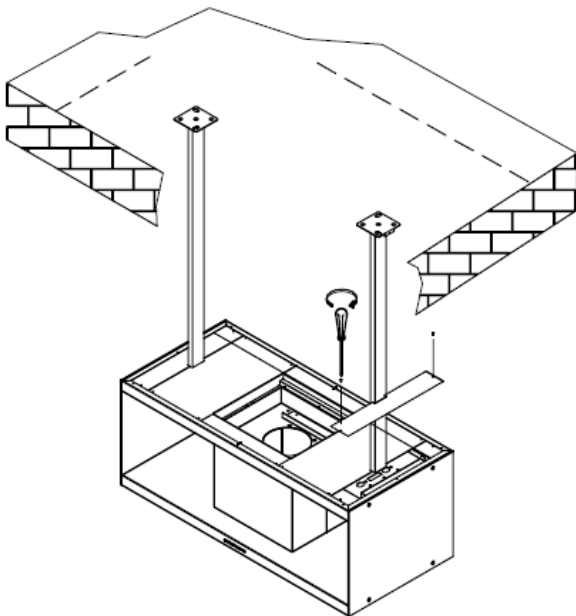

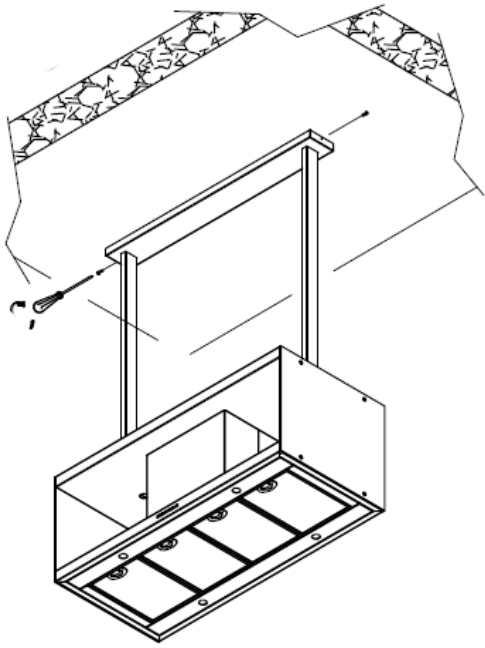

**13**

**ATTACH TRIM PLATE**

- 1.) Raise the trim plate to the upper brackets.
- 2.) Secure trim plate with screws, as shown.

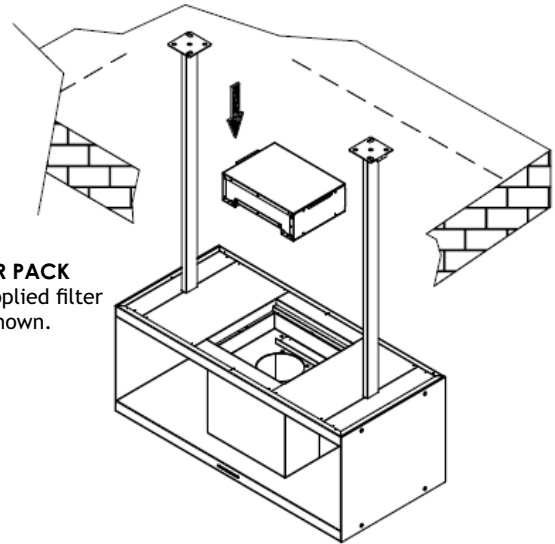

**14**

**INSTALL FILTER PACK**

Install the supplied filter package, as shown.

**15**

**CHECK RANGE HOOD**

Check the functions of the range hood to ensure proper operation.

